

Composite dry sliding bushings, metric dimensions

Principal dimensions			Basic load ratings		Mass	Designation
d	D	B	dynamic C	static C0		
mm			kN		kg	-
<b>20</b>	23	25	58,5	120	0,016	PCM 202325 M

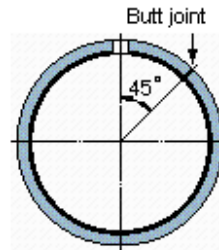
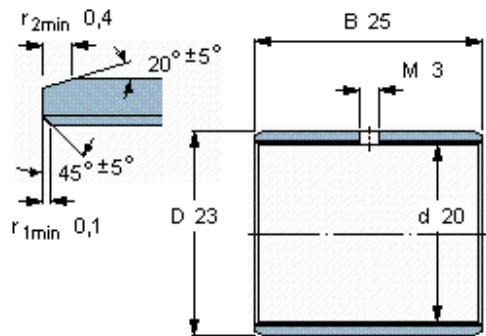

**Specific load factor** K 120  
**Material constant**  $K_M$  1900